

**American River Flood Control District
Central Valley Flood Protection Board Permit Application
1870 Claremont Road**

Staff Report

Discussion:

The parcel owner at 1870 Claremont Road in Carmichael California seeks to obtain an encroachment permit to rehabilitate the existing septic system. The parcel is located on the waterside of the District levee and is within the American River designated floodway. The work includes abandonment of the existing septic tank and installing a new tank adjacent to the existing one. The tank and all lines will be 50-feet from the levee toe.

The Board received an encroachment permit application associated with this parcel in December 2017 for a home remodel. The Board approved granting an endorsement for the application.

The structures to be modified under this request are outside the levee toe area and the proposed work will not have an impact on the District levee.

Recommendation:

The General Manager recommends that the Board of Trustees endorse the permit application.

**APPLICATION FOR A CENTRAL VALLEY FLOOD PROTECTION BOARD
ENCROACHMENT PERMIT**

Application No. _____
(For Office Use Only)

1. Description of proposed work being specific to include all items that will be covered under the issued permit.

Replacement of the existing septic system. A new septic tank and leach lines would be constructed 50 feet from the waterside levee toe. The existing septic tank and leach lines will be abandon in place.

2. Project

Location: Sutter County, in Section 28
(N) (E)
Township: 09 N (S), Range: 06 E (W), M. D. B. & M.
Latitude: 38.5983 Longitude: -121.3318
Stream: American River, Levee: Right Bank Designated Floodway: _____
APN: 283-0260-017

3. Casey Kelly of 1870 Claremont Road
Name of Applicant / Land Owner Address

Carmichael CA 95608 916-425-1075
City State Zip Code Telephone Number
ckelly@follettusa.com
E-mail

4. Ric Reinhardt of MBK Engineers
Name of Applicant's Representative Company

Sacramento CA 95825 916-456-4400
City State Zip Code Telephone Number
reinhardt@mbkengineers.com
E-mail

5. Endorsement of the proposed project from the Local Maintaining Agency (LMA):

We, the Trustees of American River Flood Control District approve this plan, subject to the following conditions:
Name of LMA

Conditions listed on back of this form Conditions Attached No Conditions

Trustee Date

Trustee Date

Trustee Date

Trustee Date

APPLICATION FOR A CENTRAL VALLEY FLOOD PROTECTION BOARD ENCROACHMENT PERMIT

6. Names and addresses of adjacent property owners sharing a common boundary with the land upon which the contents of this application apply. If additional space is required, list names and addresses on back of the application form or an attached sheet.

Name	Address	Zip Code
(see attached)		

7. Has an environmental determination been made of the proposed work under the California Environmental Quality Act of 1970? Yes No Pending

If yes or pending, give the name and address of the lead agency and State Clearinghouse Number:
CEQA Lead Agency - Sacramento County, 827 7th Street, Sacramento, CA 95814

SCH No. N/A

8. When is the project scheduled for construction? Summer 2021

9. Please check exhibits accompanying this application.
- A. Regional and vicinity maps showing the location of the proposed work.
 - B. Drawings showing plan view(s) of the proposed work to include map scale.
 - C. Drawings showing the cross section dimensions and elevations (vertical datum?) of levees, berms, stream banks, flood plain,
 - D. Drawings showing the profile elevations (vertical datum?) of levees, berms, flood plain, low flow, etc.
 - E. A minimum of four photographs depicting the project site.

1/26/21
 Signature of Applicant Date

Include any additional information:

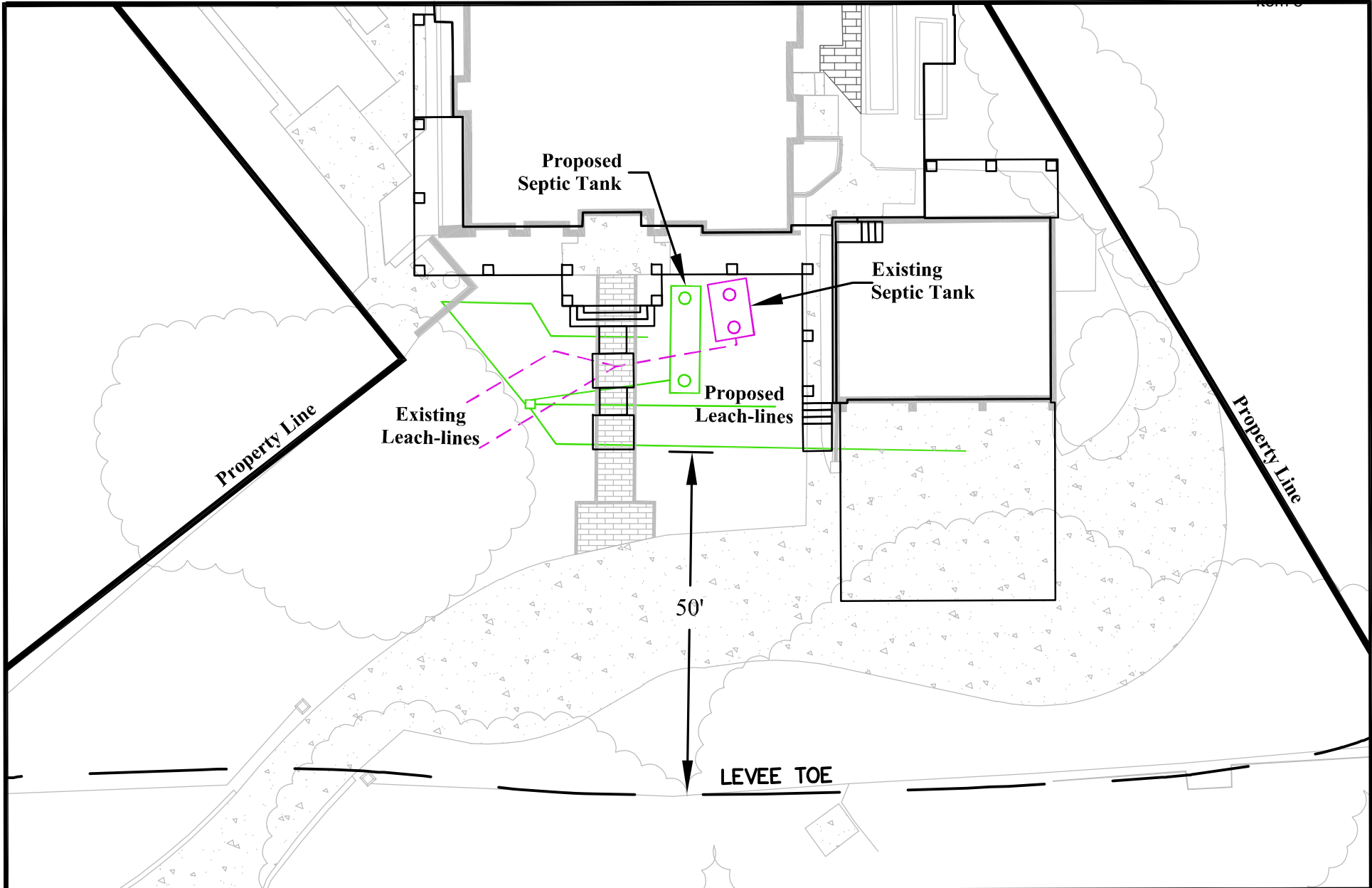

455 University Avenue, Suite 100
 Sacramento, California 95825
 Phone: (916) 456-4400 • Fax: (916) 456-0253

1870 CLAREMONT DRIVE

SEPTIC SYSTEM

SCALE:	1" = 20'
JOB NUMBER:	3221
DRAWN BY:	MB
DATE:	01/25/2021
SHEET:	1 OF 1